



DRIVES & ROLLERS

Europe/Nordic

Denmark
Interroll Nordic A/S
Hammerholmen 2-6
DK-2650 Hvidovre/Denmark
Tel. +45 36 88 33 33
Fax +45 36 88 33 72
dk-sales@interroll.com

Finland
Tel. +358 9 54 94 94 00
Fax +358 9 54 94 94 16

Iceland
Tel. +354 510 4100
Fax +354 510 4110

Norway
Tel. +47 32 88 26 00
Fax +47 32 88 26 10

Sweden
Tel. +46 35 227077
Fax +46 35 227078

Western/Southern Europe

France
Interroll France SAS
7 Avenue de la Découverte
B.P. 77017
F-21070 Dijon Cedex
Tel. +33 380 60 09 20
Fax +33 380 60 09 39
f-sales@interroll.com

Italy
Rulifi Rulmeca S.p.A.
Via A. Toscanini, 1
I-24011 Almè (Bg)
Tel. +39 035 4300111
Fax +39 035 545523
vendite@rulmeca.it

Portugal
Rulmeca Interroll de Portugal Lda
Apartado 69, Centro Cívico
P-6201-909 Covilhã
Tel. +351 275 330 780
Fax +351 275 330 789
p-sales@interroll.com

Spain
Interroll España S.A.
C.I. Santiga C/Puig dels Tudons 5
E-08210 Barbera del Vallés
Tel. +34 93 729 96 50
Fax +34 93 718 96 50
e-sales@interroll.com

United Kingdom
Interroll Automation Ltd.
Brunel Road
Earlstrees Industrial Estate
GB-Corby, Northants NN17 4UX
Tel. +44 1536 200 322
Fax +44 1536 748 505
gb-sales@interroll.com

Central Europe

Germany
Interroll Fördertechnik GmbH
Höferhof 16
D-42929 Wermelskirchen
Tel. +49 2193 23 0
Fax +49 2193 20 22
d-sales@interroll.com

Austria
Tel. +49 2193 23 187
Fax +49 2193 23 164

Belgium
Tel. +49 2193 23 131
Fax +49 2193 23 164

Luxembourg
Tel. +49 2193 23 190
Fax +49 2193 23 164

Netherlands
Tel. +49 2193 23 151
Fax +49 2193 23 164

Switzerland
Tel. +49 2193 23 190
Fax +49 2193 23 164

Eastern Europe

Germany
Interroll Fördertechnik GmbH
Höferhof 16
D-42929 Wermelskirchen
Tel. +49 2193 23 126
Fax +49 2193 23 164
d-sales@interroll.com

Hungary
Tel. +36 23 337 891
Fax +36 23 337 892

Poland
Interroll Polska sp. z o.o.
Ul. Jagiellonska 78
Pok. 3.31
PL-03-301 Warszawa
Tel. +48 22 334 63 43
Fax +48 22 675 72 92
pl-sales@interroll.com

Slovakia
Tel. +421 2 4363 8102
Fax +421 2 4342 7294

Slovenia
Tel. +386 1 56 56 370
Fax +386 1 56 56 372

Czech Republic
Interroll CZ S.R.O.
Ullice G. Simka 3147
CZ-69003 Breclav
Tel. +420 627 330 210
Fax +420 627 330 211
cz-sales@interroll.com

Turkey

Roller Makina San. Ve. Tic. Ltd. Sti.
Zihni Sakaryali Ali Sok.
Ufuk Apt. No. 1 D. 11
Ersoy Sahil Sitesi
81070 Suadiye
Istanbul
Tel. +90 216 386 37 75
Fax +90 216 386 38 22
tr-sales@interroll.com

Near East

Israel
ComTrans Engineering Ltd.
5 Hahoma Street
Rishon le-Zion 75655
Tel. +972 3 961 96 36
Fax +972 3 961 96 44
il-sales@interroll.com

Africa

South Africa
Interroll SA Pty. Ltd.
P.O. Box 327
Isando 1600
ZA-Gauteng
Tel. +27 11 974 1901
Fax +27 11 974 1896
za-sales@interroll.com

North & South America

Canada
Interroll Canada Ltd.
1201 Gorham Street
CDN-Newmarket
Ontario L3Y 1V1, Canada
Tel. +1 905 727 33 99
Fax +1 905 727 32 99
cdn-sales@interroll.com

USA
Interroll Corporation
3000 Corporate Drive
USA-Wilmington, NC 28405
Tel. +1 910 799 11 00
Fax +1 910 392 38 22
usa-sales@interroll.com

Argentina
Interroll South America
Calle 117, No. 3591
B1650NRU San Martin
Provincia de Buenos Aires
Tel. +54 11 4753 8005
Fax +54 11 4754 1332
ar-sales@interroll.com

Brasil
Interroll Brasil
Av. Portugal 918
CEP 06651-970
Itapevi - SP
Tel. +55 11 4143 7704
Fax +55 11 4141 28 68
br-sales@interroll.com

www.interroll.com

Asia

Singapore
Interroll (Asia) Pte. Ltd.
11 Kian Teck Drive
628828 Republic of Singapore
Tel. +65 6266 6322
Fax +65 6266 6849
sgp-sales@interroll.com

China
Interroll (Suzhou) Co. Ltd.
Clock C1-C2
Suhong Industrial Square
81 Suhong West Road
Suzhou Industrial Park
Jiangsu Province
215021 People's Republic of China
Tel. +86 512 6256 0381
Fax +86 512 6256 0385
cn-sales@interroll.com

Japan
Interroll Japan Co. Ltd.
Tokyo Genboku Kaikan 10F
5-30-13 Toyo, Koto-Ku
Tokyo 135-0016
Tel. +81 3 5617 8071
Fax +81 3 5617 8072
jpn-sales@interroll.com

Korea
Interroll (Korea) Co. Ltd.
Room 301, Dongsan Bldg, 333-60
Shindang-Dong, Choong-ku
Seoul
Tel. +822 2 231 1900
Fax +822 2 254 36 83
kr-sales@interroll.com

Thailand
Interroll (Thailand) Co. Ltd.
41/6 Moo 6, Bangchalong,
Bangplee
Samutprakarn 10540
Tel. +66 2 337 0188 91
Fax +66 2 337 01 92
th-sales@interroll.com
Other Asian countries:
please contact Singapore

Australia & New Zealand

Australia
ABC Components Pty. Ltd.
70 Keon Parade
Keon Park 3073
Melbourne
Tel. +61 3 9460 2155
Fax +61 3 9460 2029
aus-sales@interroll.com

New Zealand
ABC Conveying Systems
42 Parkway Drive
Mairangi Bay
NZ-Auckland 10
Tel. +64 9 478 6150
Fax +64 9 479 6394
nz-sales@interroll.com

www.interroll.com/b2b
(with online shop)

PUT THEM IN THE DRIVING SEAT!



WE MAKE THE WORLD MOVE

UNIQUE: INTERROLL'S NEW BELT DRIVES 80S DC AND 113S DC



Food processing, recycling, checkout stands, paper, cardboard and other industries: *If you are ready for the next step in state-of-the-art belt conveyor technology, put Interroll's latest product innovations in the driving seat!*

Interroll has introduced a completely new concept of belt drives providing maximum performance with low voltage. Interroll's 24 V DC Belt Drives - unique in the market - provide a premium package of advantages including:

- low voltage for higher safety
- 24 V DC for universal connection
- adjustable speed
- IP66/67 encapsulation
- low weight
- easy installation

- **Fast and easy installation**
Installation is simple and straightforward. All that is required is the fitting of two brackets, mounting and alignment of the motor and connection of the cables. Simply twice as fast as installing conventional drives.
- **Low noise**
Thanks to the totally sealed enclosure and high quality gears the Interroll DC Belt Drives run almost at a whisper. All components are encapsulated.
- **Cleanliness**
Because the Interroll Belt Drives 80S DC/113S DC are totally enclosed, they cannot contaminate foodstuffs, electrical components, plastics and other such materials that must be kept perfectly clean during handling.
- **Virtually maintenance-free**
Interroll DC Belt Drives are maintenance-free. Internal parts are lubricated for lifetime.
- **Factory fitted safety**
Since the only moving part of an Interroll DC Belt Drive is the rotating shell, it is safer than conventional drives safeguarding both people and goods. Low 24 V DC enhances safety even further.
- **Unmatched efficiency**
For unparalleled efficiency and reduced energy consumption, the Interroll DC Belt Drives are powered by an internal gearbox combined with a permanent magnet DC motor. This makes Interroll DC Belt Drives a most economical solution.
- **Space saving design, few parts**
A Interroll Belt Drive offers maximum power in minimal space. It consists of the drive and two fixing brackets only! Conventional drives are often more expensive because they require numerous separate components from different suppliers.

PRODUCT
NEWS 4/03

Technical Data:

Interroll Belt Drives 80S DC and 113S DC

How does it function?

The construction of the Interroll Belt Drives 80S DC/113S DC with DC motor is similar to the standard versions 80S/113S, but with a permanent magnet brush type DC motor and without oil. The gear box of the Interroll Belt Drives 80S DC/113S DC is lubricated for life with grease. It is primarily used in belt conveyors. For other applications please contact Interroll.

What are the diameters?

The standard shell diameters are $\varnothing 80$ mm and $\varnothing 113$ mm.

And what about the speed?

- Nominal voltage: 24 V DC
- Nominal Current: 2.7 A
- Please note that the speed is dependent on the load.
- Locket rotor current IK: 18 A

- The motor is EMC protected, and CE marked.
- Minimum cable length: 1.1 m outside shaft
- Allowable ambient temperature: 0° to 40°C
- Steel executions: full stainless steel or standard mild steel
- Cable: halogen-free cable is standard
- Recommended power supply type: regulated switch mode



Advantages and features at a glance:

- Standard voltage for the Interroll Belt Drives 80S DC/113S DC is 24 V DC, but other voltages can be supplied upon request.
- Voltage adjustable for variable speed
- High starting torque 300%
- Dynamic braking possible
- Reversible
- Low noise level
- Min. RL = 295 mm, max. RL = 962 mm
- The Interroll Belt Drives 80S DC/113S DC must be current protected for overload protection of gearbox and DC motor.
- Approximate speeds, torque and belt pull (see tables on next page)
- IP66/67 protection
- Min. expected lifetime: 3000 operation hours / 3 Mio. starts/stops
- Max. starts/stops: 20 per minute

Standard dimensions Interroll 80S DC and 113S DC Belt Drives

Interroll Belt Drive, global standard

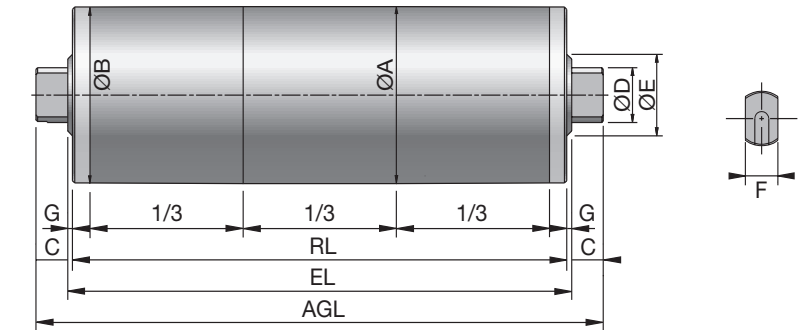

* allow 2.2 mm for cable protrusion

	A mm	B mm	C mm	D mm	E mm	F mm	G mm	RL mm	EL mm	AGL mm
80S DC	81,5	80	20	35	45	21	3	2,2	RL+6	RL+46
113S DC	113,5	112,5	20	35	45	21	3	2,2	RL+6	RL+46

Interroll Belt Drive 80S DC

Motor

Power kW/HP	Voltage	Current IF	Gear stage	Nominal belt speed at full load m/s	Belt speed at no load m/s	Torque Nm	Belt pull N	Min. RL mm	Max. radial load (T1+T2) in N	Standard IP67 Weight kg RL 295 to 962							
0.060/0.082	24V DC	2.7 A	3	0,12	0,14	12,6	315	295	2000	4.1 to 9.2							
				0,15	0,17	10,5	263										
				0,18	0,21	8,6	215										
				0,20	0,23	7,8	195										
				0,23	0,26	7,0	175										
				0,27	0,31	5,8	145										
				0,30	0,34	5,4	135										
				0,33	0,38	4,7	118										
							2				0,76	0,84	1,6	40	295	1500	
											0,90	1,00	1,3	33			
1,10	1,23	1,1	28														

Interroll Belt Drive 113S DC

Motor

Power kW/HP	Voltage	Current IF	Gear stage	Nominal belt speed at full load m/s	Belt speed at no load m/s	Torque Nm	Belt pull N	Min. RL mm	Max. radial load (T1+T2) in N	Standard IP67 Weight kg RL 295 to 962							
0.060/0.082	24V DC	2.7 A	3	0,18	0,20	12,6	224	295	2000	5.5 to 13,0							
				0,21	0,24	10,5	186										
				0,26	0,30	8,6	152										
				0,29	0,33	7,8	139										
				0,32	0,37	7,0	123										
				0,39	0,44	5,8	103										
				0,42	0,48	5,4	95										
				0,47	0,54	4,7	84										
							2				1,07	1,18	1,6	29	295	1500	
											1,28	1,42	1,3	24			
1,56	1,73	1,1	19														